

LED Wall Light Installation Instruction

IMPORTANT SAFETY INFORMATION



- # Ensure the lamp voltage is consistent with the supply voltage.
- # Ensure power is switched OFF from the switchboard before installation.
- # This product must be installed by a licensed electrician.

- 1 Reserve outgoing wires, turn off the power, Loosen the side screw of the lamp body and open the base;

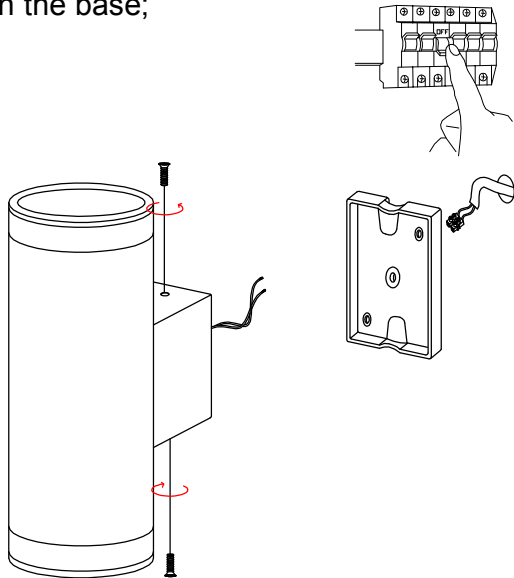

- 2 The wire of the wall passes through the bottom base and connect with the lamp wire, fix the bottom base on the wall with the screws;

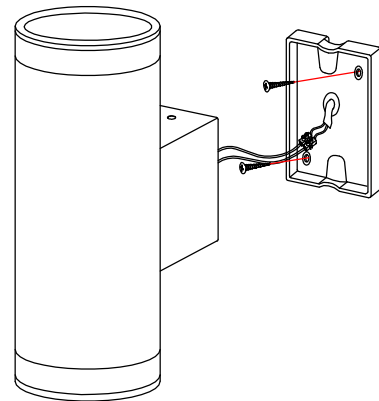

- 3 Fix the lamp body on the bottom base with the side screw;

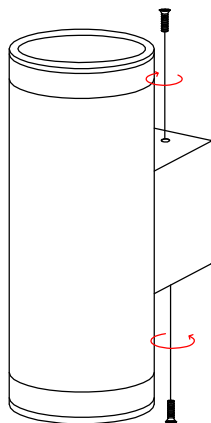

- 4 Check whether it is firm, electrify test and complete installation.

