

Driver LC 25W 500/600mA fixC SR SNC2 China Domestic
essence标准版系列

**产品描述**

- _ 带应变消除外壳的独立 LED 驱动
- _ 最大输出功率25W
- _ 输出电流500 或 600 mA
- _ 适用M类和MM类应用环境，符合 EN 60598, VDE 0710, VDE 0711
- _ 耐热保护符合EN61347-2-13 C5e标准
- _ 高达30,000小时的额定寿命
- _ 3年质保

特性

- _ 外壳: PC塑料, 白色
- _ 安全等级IP20
- _ 插入式端子
- _ 2个独立的应力消除部件，用于输入和输出电缆，具有高度坚固的夹具

功能

- _ 过载保护
- _ 短路保护
- _ 空载保护
- _ 电源开关时无输出电流过冲
- _ 爆炸保护电压 1kV
- _ 浪涌保护电压 1 千伏 (L 和 N 之间)
- _ 浪涌保护电压 2 千伏 (L/N 和接地之间)

Website

<http://www.tridonic.cn/23000273>



Spotlights



Downlights



Linear



Area



Floor | Wall



Free-standing



Street



Decorative



High bay

Driver LC 25W 500/600mA fixC SR SNC2 China Domestic essence标准版系列

您可以在下载区域找到这一产品的完整数据资料。

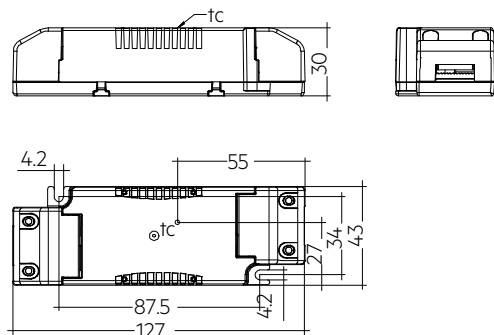

Ordering data

Type	Article number	Packaging, carton	Packaging, low volume	Packaging, high volume	Weight per pc.
LC 25/600/42 fixC SR SNC2	23000273	14 pc(s).	364 pc(s).	2.548 pc(s).	0.096 kg

Technical data

Rated supply voltage	220 - 240 V
交流电压范围	198 - 264 V
Mains frequency	50 / 60 Hz
Overvoltage protection	320 V AC, 1 h
Leakage current (at 230 V, 50 Hz, full load)	< 450 μ A
THD (at 230 V, 50 Hz, full load)	< 20 %
Output current tolerance ^①	\pm 7.5 %
Typical output LF current ripple at full load ^②	\pm 25 %
Starting time (at 230 V, 50 Hz, full load)	\leq 0.5 s
Turn off time (at 230 V, 50 Hz, full load)	\leq 0.5 s
Hold on time at power failure (output)	0 s
环境温度 t_a	-20 ... +50 °C
Ambient temperature t_a (at life-time 30,000 h)	40 °C
Storage temperature t_s	-40 ... +80 °C
尺寸长 x 宽 x 高	127 x 43 x 30 mm

Approval marks

IP20 SELV

Standards

EN 55015, EN 61000-3-2, EN 61000-3-3, EN 61347-1, EN 61347-2-13, EN 61547, EN 60598-1

Specific technical data

Type	输出电流 ^①	Input current (at 230 V, 50 Hz, full load)	Max. input power	Typ. power consumption (at 230 V, 50 Hz, full)	Output power range	λ at full load	Efficiency at full load ^②	λ at min. load	Efficiency at min. load ^②	Min. forward voltage	Max. forward voltage	Max. output voltage (U-OUT)	Max. output peak current at full load ^②	Max. output peak current at min. load ^②	Max. casing temperature t_c
LC 25/600/42 fixC SR SNC2	600 mA	0.135 A	29 W	27.5 W	16.2 - 25.2 W	0.93C	90 %	0.88C	88 %	27 V	42 V	60 V	840 mA	970 mA	70 °C

^① Output current is mean value.

^② Typical value at full load, depend on load's V-I character.

③ Test result at 230 V, 50 Hz.

④ The trend between min. and full load is linear and depend on load's V-I character.