

9290 008 65408

Brand Name	XITANIUM
Description	Xitanium 50W 0.7A
Input Voltage	220~240V
Input Frequency	50/60Hz
RoHS	Yes
Status	Released

Electrical Specifications

Output Power (W)	Output Voltage (V)	Output Current (A)	Efficiency@ Max Load			Max Case Temp. (°C)	Input Current			Max. Input Power (W)	Inrush Current (A _{ip} /50%-μs)		THD @ Max Load (%)	Power Factor@ Max Load	Surge Protection Common/Diff (KV/2Ohm)	Weight (kgs)
			220 V	230 V	240 V		2 0 0v	2 2 0v	2 40v		200 Vin	7.0/60.2				
50	35 ~ 71	0.700	89.0	89.1	89.0	80 °C	0.278	0.258	0.239	56	200 Vin	7.0/60.2	20	>0.95	4/4	0.36
			220 V	230 V	240 V		2 0 0v	2 2 0v	2 40v		230 Vin	7.1/61.2				
			89.0	89.1	89.0		0.278	0.258	0.239		240 Vin	7.4 / 59.8				

Wire Diagram

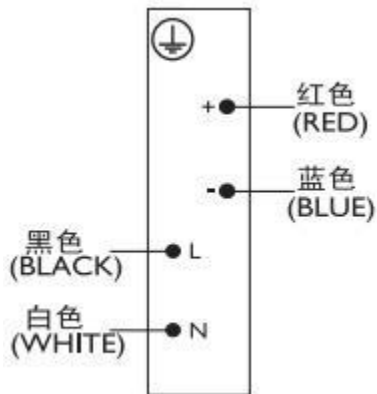

Input and output use lead-wires.

Lead-wires are 18AWG 105C/600V solid copper.

Lead Length outside the enclosure: 315 mm (±10mm) on all

Enclosure

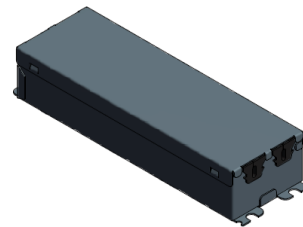

	mm
Case Length	127
Case Width	44
Case Height	30
Mounting Length	135
Mounting Width	26
Overall Length	140



Revised 03/15/2013

Electrical Specifications

9290 008 65408	
Brand Name	XITANIUM
Description	Xitanium 50W 0.7A
Input Voltage	220~240V
Input Frequency	50/60Hz
RoHS	Yes
Status	Released

Product Data	
Order code	9290 008 65408
Full product code	9290 008 65408
Full product name	Xitanium 50W 0.70A 230V-J cXt
Net weight per piece	0.36 kg
Interfaces	No
Ambient Temp Range	-40C to +55C
Corresponding Tcase	-15C to +80C
Shipment and Storage Temp	-40C to +80C
Shipment and Storage Humidity	10% to 95% RH
Line Voltage	220-240V (certified) and 150-305V (workable)
Line Current	0.258A/220V
Line Frequency	50/60
Life @ TC 70 C	100,000 hr [nom] refer to graph below
Life @ TC 80 C	50,000 hr [nom] refer to graph below
Max TC	80C
Inrush current Width	Refer to table
Maximum ballast number on MCB 16A	11 [max]
Input Over-voltage	Can survive input over-voltage stress of 320VAC for 48 hours and 350VAC for 2 hours
LED Current Tolerance	+/-5%
Earth leakage current	0.7 mA [max]
Mains voltage safety (AC)	+/-10%
Mains voltage performance (AC)	+/-10%
Min. Mains voltage operational	198 V [min]
Output max voltage (rms)	100V dc[max]
Output Current ripple	30% @ Max Load (ripple = pk-pk/2 x avg)
THD total	< 20% @ Max Load
THD 3 rd Harmonic	< 15% @ Max Load
PF @ Max Load	> 0.95
Wire Isolation	All wires are Basic isolated to ground
Protections	Short Circuit and Open Circuit Protection for LED + and LED-

Installation & Application Notes:

Section I – Physical Characteristics

- 1.1 LED Driver shall be installed inside an electrical enclosure
- 1.2 External SPD has to be added to work with this driver in the luminaire design.
- 1.3 Wiring inside electrical enclosure shall comply with 600V/105°C rating or higher.

Section II – Performance

- 2.1 LED Driver has a rated lifetime of 50,000 hours @ TC ≤80C.
- 2.2 LED Driver tolerates sustained open circuit and short circuit output conditions without damage.
- 2.3 LED Driver maximum allowable case temperature is 80°C – see product label for measurement location.
- 2.4 LED Driver reduces output power to LEDs if its case temperature exceeds >90°C –thermal protection and eventually reduces output current to zero.
- 2.5 LED Driver complies with the requirements of CE, CISPR 15 Ed 7.2 and CQC.

Revised 03/15/2013

9290 008 65408

Brand Name	XITANIUM
Description	Xitanium 50W 0.7A
Input Voltage	220~240V
Input Frequency	50/60Hz
RoHS	Yes
Status	Released

Electrical Specifications

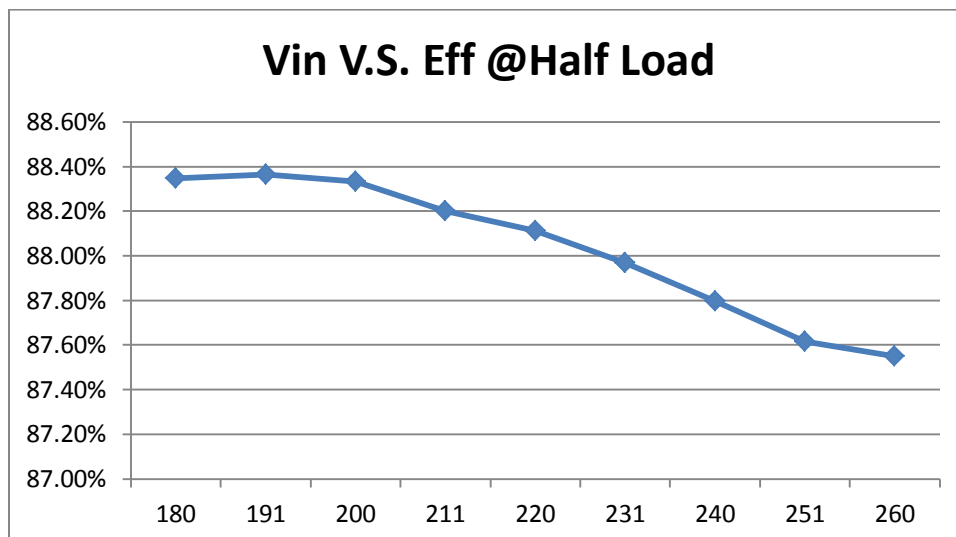
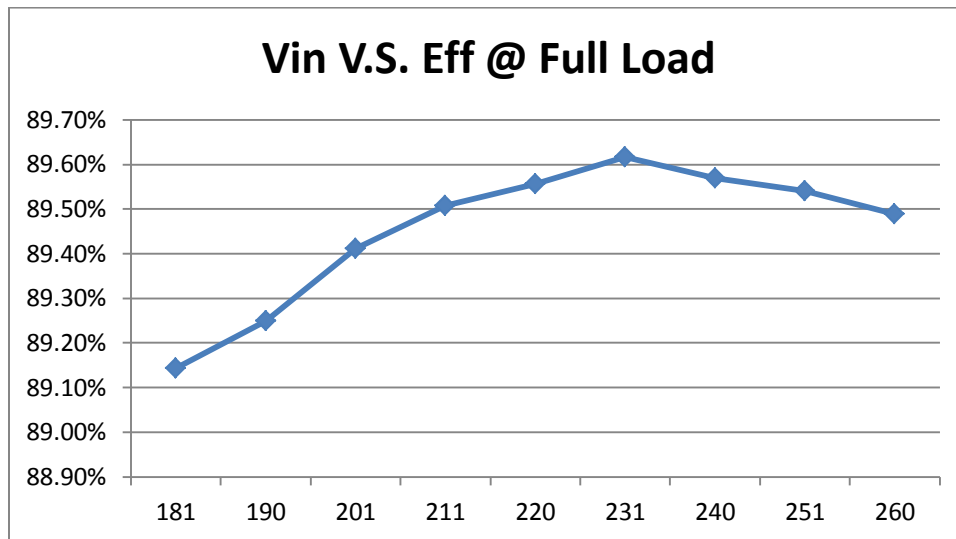

Revised 03/15/2013



9290 008 65408	
Brand Name	XITANIUM
Description	Xitanium 50W 0.7A
Input Voltage	220~240V
Input Frequency	50/60Hz
RoHS	Yes
Status	Released

Electrical Specifications

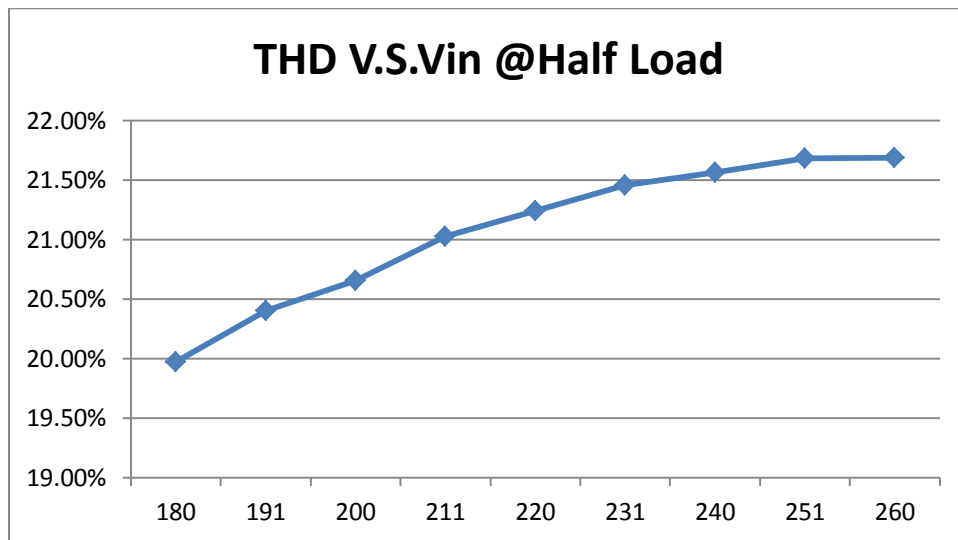
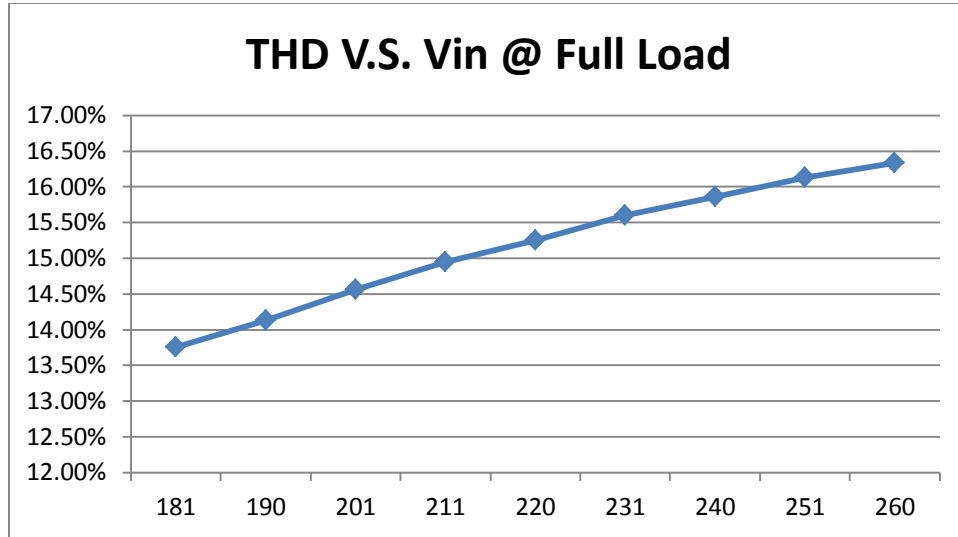

Revised 03/15/2013



9290 008 65408

Brand Name	XITANIUM
Description	Xitanium 50W 0.7A
Input Voltage	220~240V
Input Frequency	50/60Hz
RoHS	Yes
Status	Released

Electrical Specifications

Performance vs. Ambient temperature

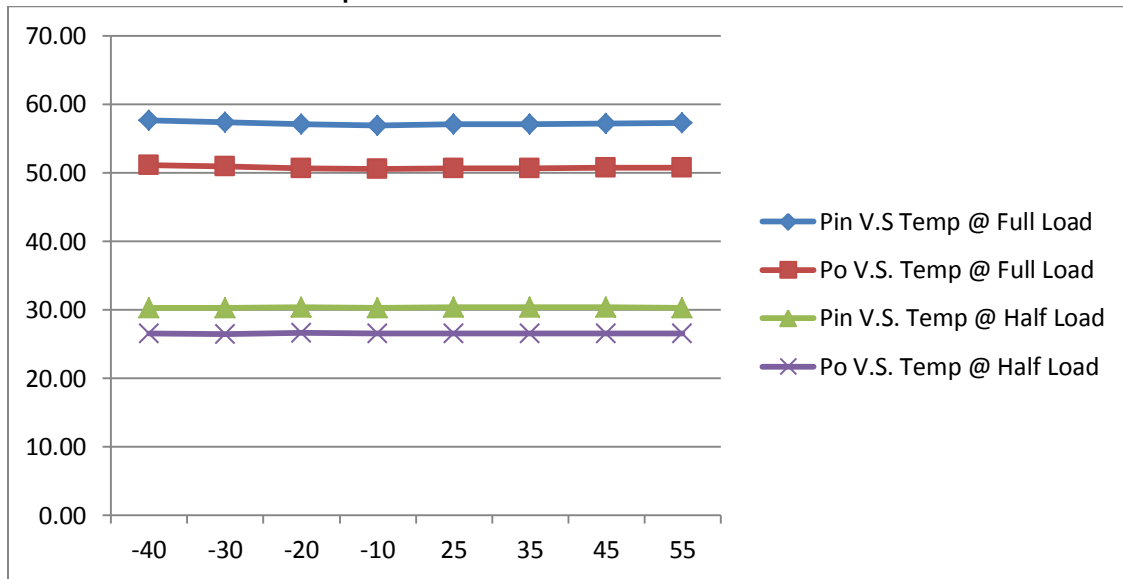

Io vs. Ambient temperature

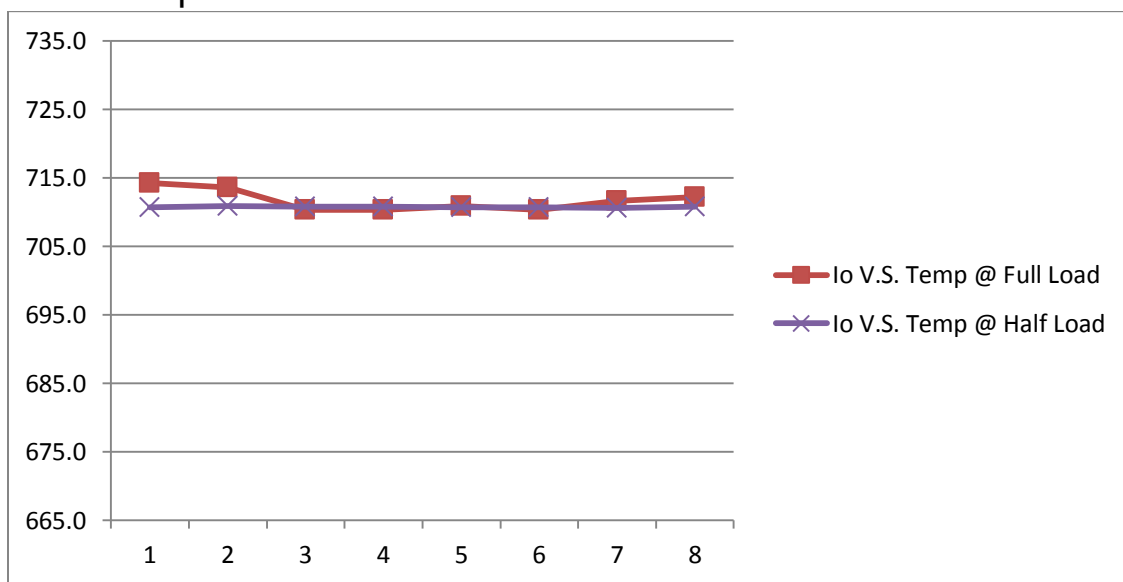

Revised 03/15/2013



9290 008 65408	
Brand Name	XITANIUM
Description	Xitanium 50W 0.7A
Input Voltage	220~240V
Input Frequency	50/60Hz
RoHS	Yes
Status	Released

Electrical Specifications

THD vs. Ambient temperature

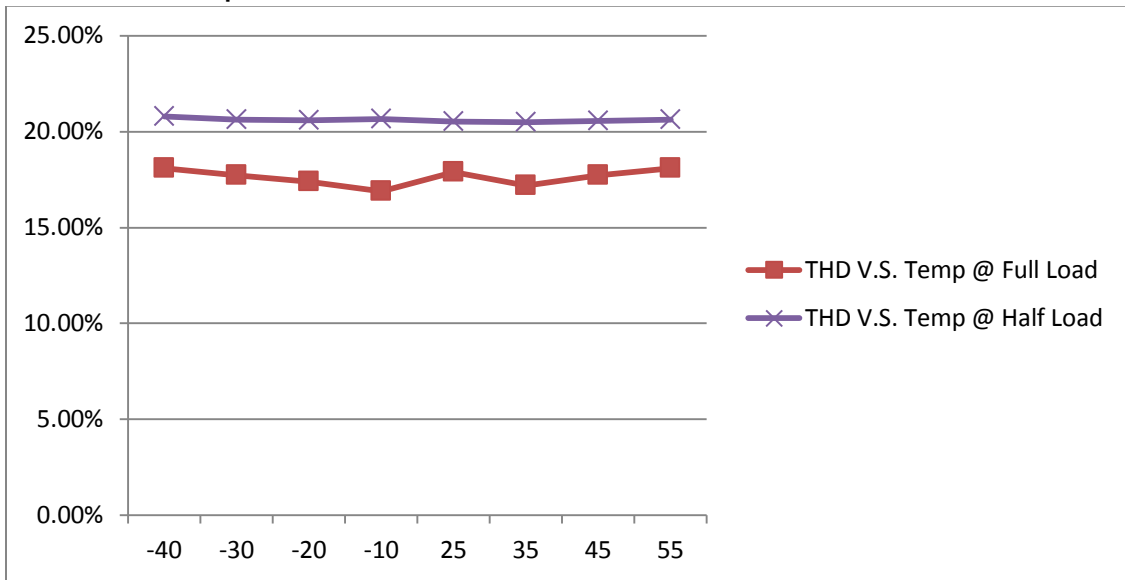

Effi vs. Ambient temperature

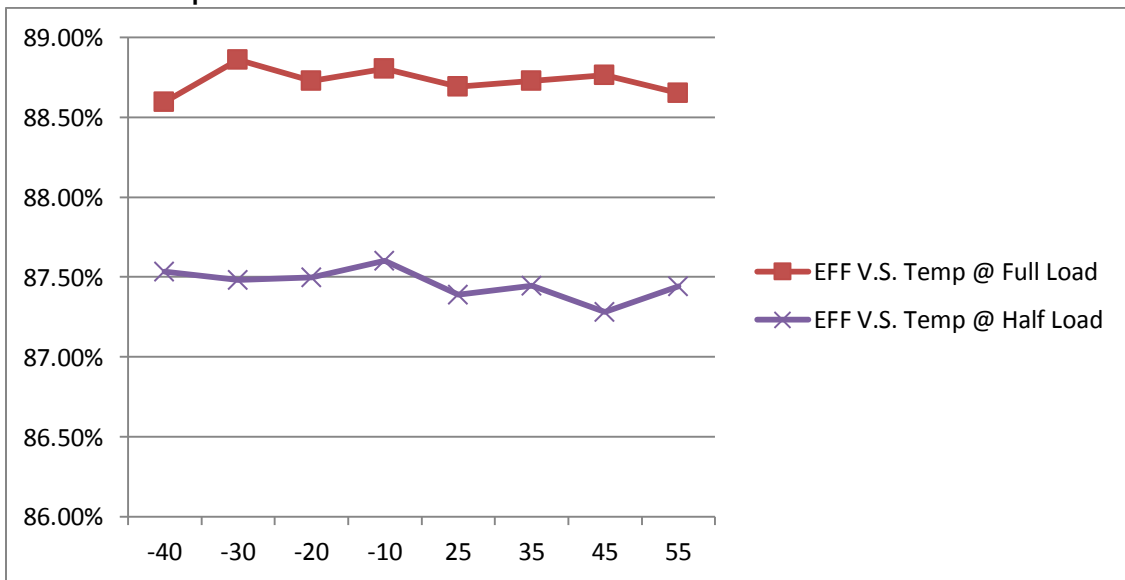

Revised 03/15/2013

9290 008 65408	
Brand Name	XITANIUM
Description	Xitanium 50W 0.7A
Input Voltage	220~240V
Input Frequency	50/60Hz
RoHS	Yes
Status	Released

Electrical Specifications

I_{out} vs. T_{case} of Driver:

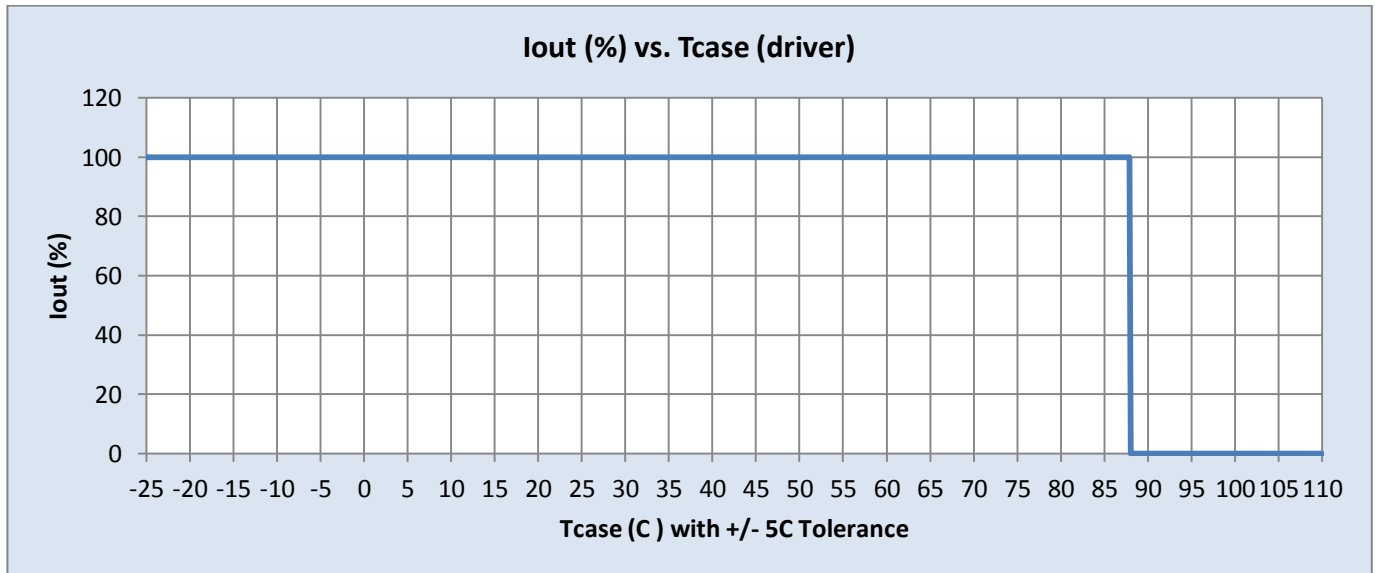

Inrush Current Info:

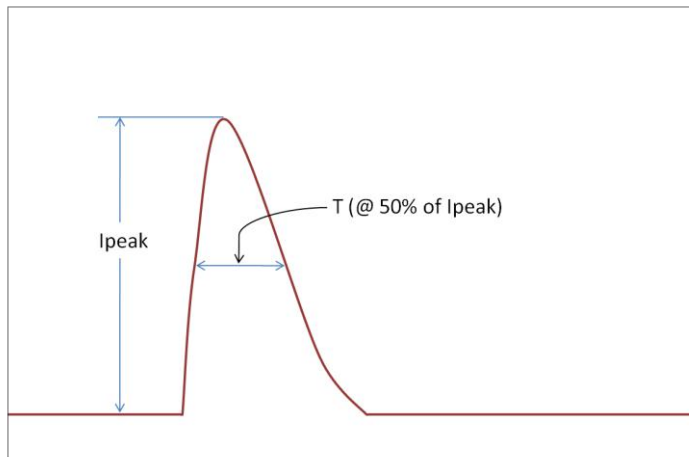

V _{in}	I _{peak}	T (@ 50% of I _{peak})
200 Vrms	7.0 A	60.2 μs
230 Vrms	7.1 A	61.2 μs
240 Vrms	7.4A	59.8 μs

Revised 03/15/2013



9290 008 65408	
Brand Name	XITANIUM
Description	Xitanium 50W 0.7A
Input Voltage	220~240V
Input Frequency	50/60Hz
RoHS	Yes
Status	Released

Electrical Specifications

Lifetime vs. Tcase of Driver:

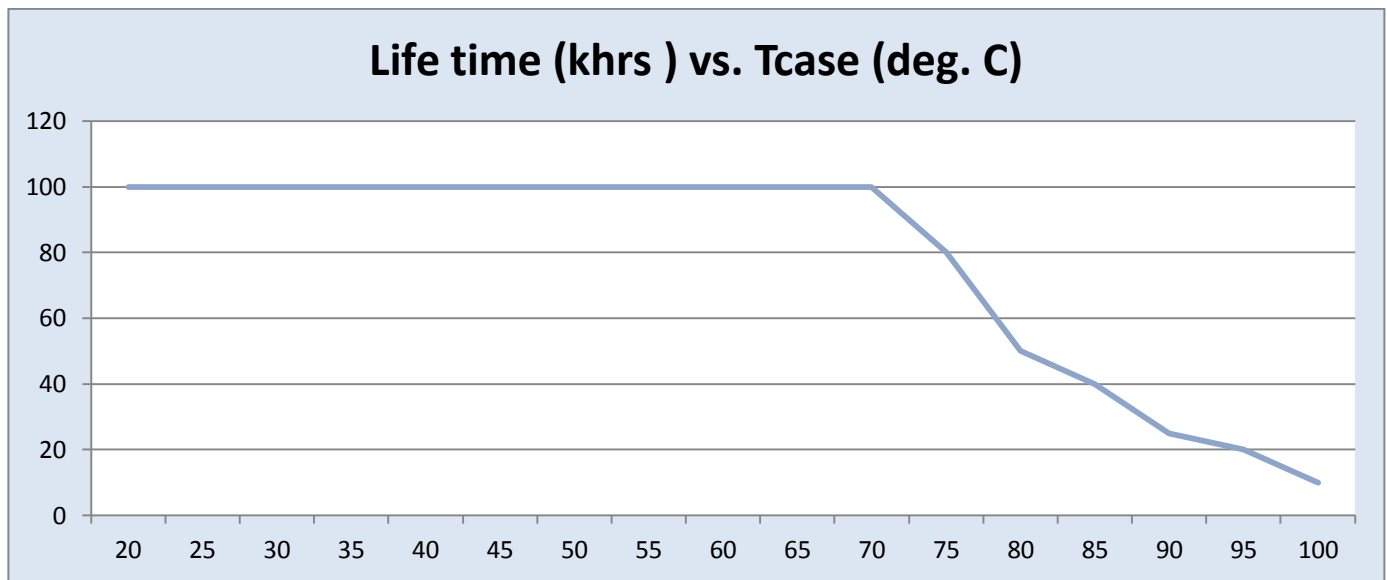

Failure Rate Info: <0.01% per 1 kHr @<= Tcase 70 C

Isolation:

Isolation	Input Wires	Output Wires	Chassis
Input Wires	NA	1480Vac	1480Vac
Output Wires	1480Vac	NA	1480Vac
Chassis	1480Vac	1480Vac	NA

Revised 03/15/2013

9290 008 65408	
Brand Name	XITANIUM
Description	Xitanium 50W 0.7A
Input Voltage	220~240V
Input Frequency	50/60Hz
RoHS	Yes
Status	Released

Electrical Specifications

Mechanical Drawing:

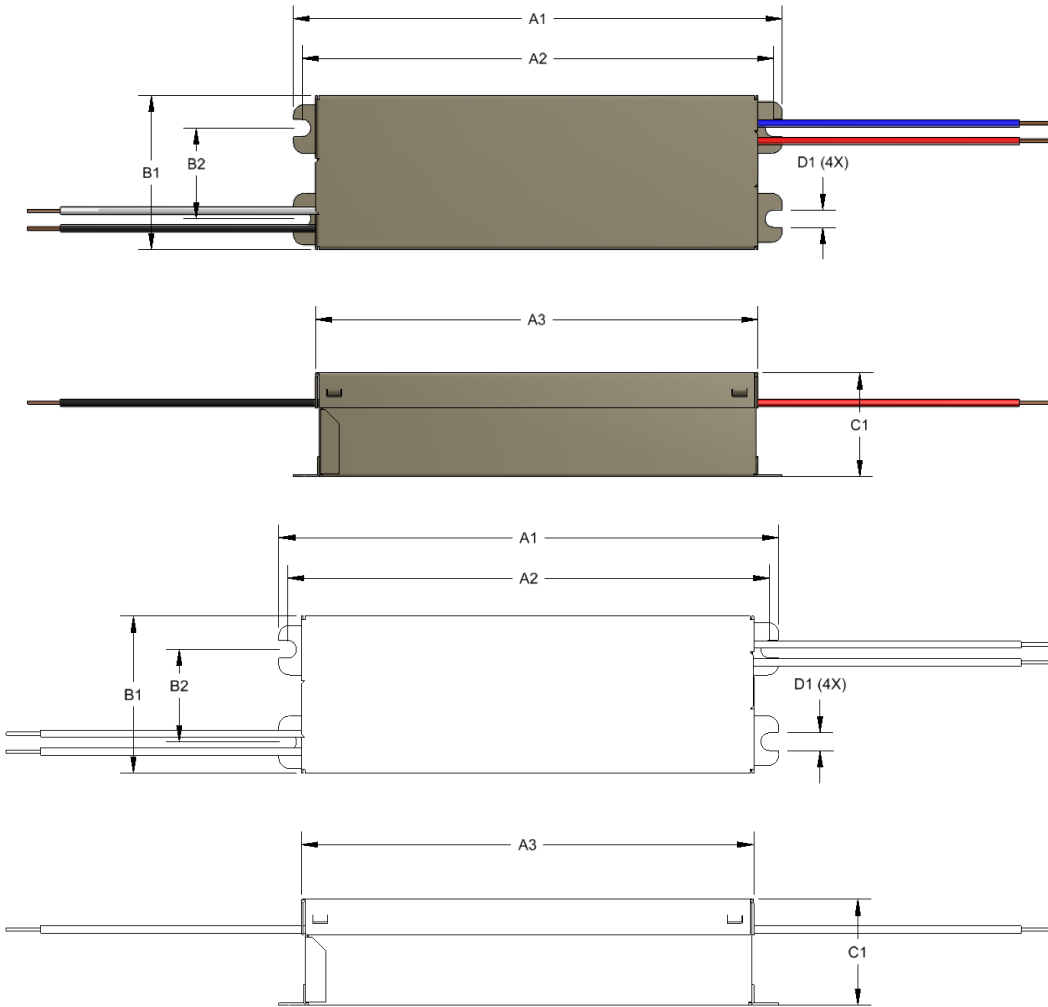

A1	A2	A3	B1	B2	C1	D1
140	135	127	44	26	30	4.1

Revised 03/15/2013