

Constant Current LED Driver

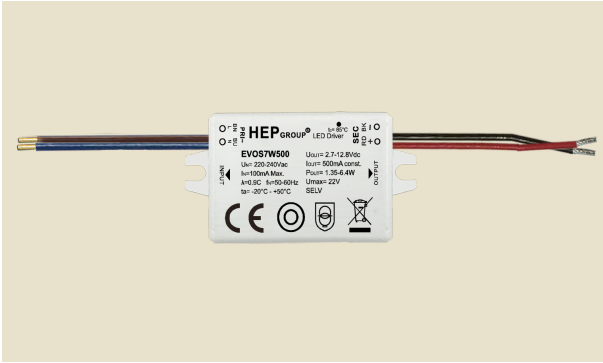

Electronic

Parameter	Conditions	Min	Nom	Max	Unit	
Rated Input Voltage		198	220-240	264	Vac	
Input Frequency		47	50-60	63	Hz	
Input Current		-	-	100	mA	
Output Voltage Range	EVOS7W350P	-	2.7-19.2	-	Vdc	
	EVOS7W500P	-	2.7-12.8	-	Vdc	
	EVOS7W700P	-	2.7-9.6	-	Vdc	
Rated Output Power	EVOS7W350P	1	-	6.7	W	
	EVOS7W500P	1.4	-	6.4	W	
	EVOS7W700P	1.9	-	6.7	W	
Power Factor		0.50	-	-	-	
Efficiency	EVOS7W350P	Full Load	-	75	%	
	EVOS7W500P	Full Load	-	73	%	
	EVOS7W700P	Full Load	-	71	%	
Ripple Current	EVOS7W350P	peak to peak @ full load	-	-	±20	%
	EVOS7W500P/700P	peak to peak @ full load	-	-	±25	%
Output Current Tolerance		-	±5	-	%	
Turn-on Delay Time	@230 VAC	-	0.5	-	S	
Protection		No Load Protection				
		Overload Protection				
		Short Current Protection				
RoHS Standard		Compliant				
Case Temp. (Tc)		-	-	85	°C	
External Operating Temperature		-20	-	+50	°C	
Operating Humidity Range		10	-	100	%	
Storage Temp. Range		-20	-	+85	°C	
Lifetime	Ta = 40°C	-	30,000	-	hrs	
Case Dimensions	L x W x H	49	27.2	20	mm	

Constant Current LED Driver

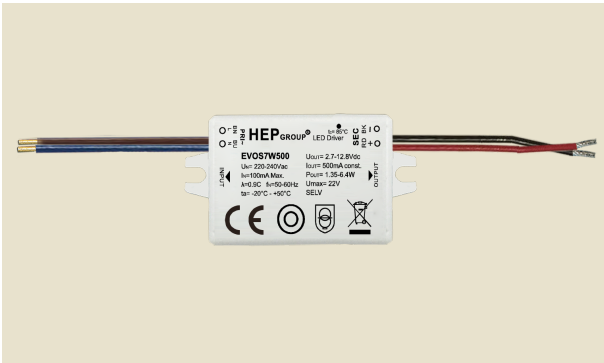

Physical Parameter

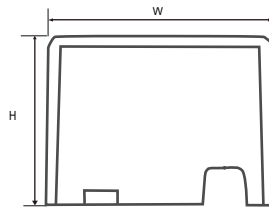
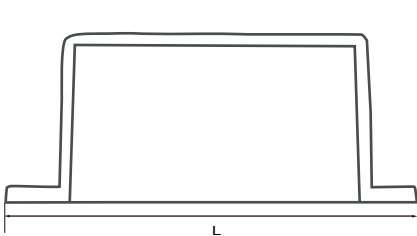

L : 49 mm W: 27.2 mm H : 20 mm
Tolerance : $\geq 0 \sim 100 \geq \pm 0.5\text{mm}$
 $100 \geq \pm 1 \text{ mm}$
Housing Material : Polycarbonate : Potted
Soldering : Lead-Free, Comply With RoHS
Label : Surface Print

Wiring Diagram

