

## Constant Current LED Driver

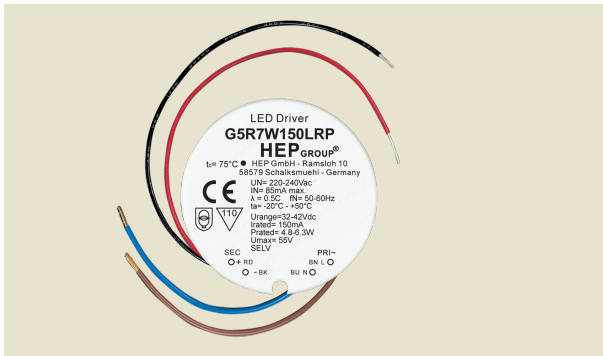

### Approval Marks



### Electronic

Parameter	Conditions	Min	Nom	Max	Unit
I/P Voltage Range		220	230	240	Vac
Input Frequency		50	50	60	Hz
Input Power	G5R7W150LRP High Power LED	5.4	-	9	W
	G5R7W350LRP High Power LED	5.68	-	9.63	W
	G5R7W500 High Power LED	4	-	8.5	W
Input Current	@230V	-	-	85	mA
Output Voltage Range	G5R7W150LRP	32	-	42	Vdc
	G5R7W350LRP	13	-	22	Vdc
	G5R7W500LRP	6	-	13	Vdc
Output Current Range	G5R7W150LRP	142	150	158	mA
	G5R7W350LRP	335	350	367	mA
	G5R7W500LRP	475	500	525	mA
Rated Output Power	G5R7W150LRP	4.8	-	6.3	W
	G5R7W350LRP	4.55	-	7.7	W
	G5R7W500	3	-	6.5	W
No-Load Voltage	G5R7W150LRP	-	-	55	V
	G5R7W350LRP	-	-	35	V
	G5R7W500LRP	-	-	18	V
Efficiency	Full Load	-	80	-	%
Standby Power		-	-	0.5	W
Rise Time		-	-	500	ms
Start-up Delay		-	-	500	ms
Ripple Current	Peak to peak @ full load@full O/P voltage range	-	-	10	%
Output Current Overshoot		-	-	20	%
Power Factor	Full Load	0.5C	-	-	-
Protection	Over-voltage Protection		Auto recovery		
	Open-circuit Protection		Max output voltage at no load		
	Short-circuit Protection		Auto recovery		
RoHS Standard			Compliant		
Case Temp. (Tc)	@Ta=50°C	-	-	75	°C
	@Ta=60°C	-	-	85	°C
External Operating Temperature		-20	-	+50	°C
Operating humidity range		10	-	90	%
Storage Temp. range		-25	-	+85	°C
Lifetime	at Max Case hot spot Temperature @Tc=75°C	-	-	50,000	hrs
	at Max Case hot spot Temperature @Tc=85°C	-	-	30,000	hrs
Case Dimensions	∅L x H	43	-	20	mm



ower for light

### Constant Current LED Driver

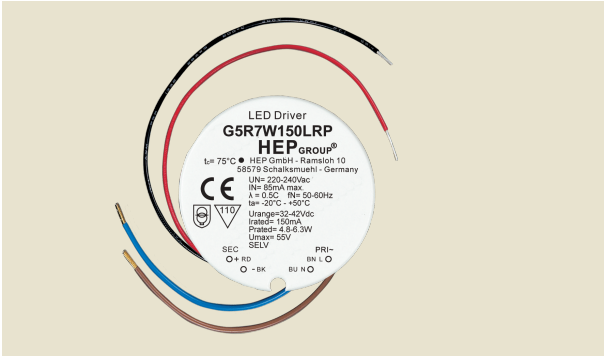

### Approval Marks



### Physical Parameter

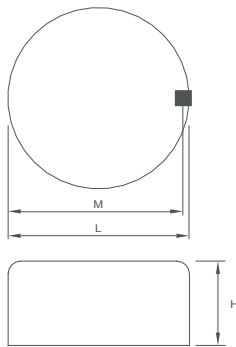

L : 43 mm	H : 20 mm
M : 41.5 mm	K : mm
N : mm	R : 1.6 mm
W : mm	
Tolerance : $\geq 0 \sim 100 \geq \pm 0.5\text{mm}$	
$100 \geq \pm 1 \text{ mm}$	

- Terminal Block : Hard Wires : PRI : Blue / Brown 145mm AWG #18  
SEC : Red / Black 145mm AWG #22
- Housing Material : Polycarbonate / Potting
- Soldering : Lead-Free, Comply With RoHS
- Label : Surface Print

### Wiring Diagram

