

### Constant Current LED Driver

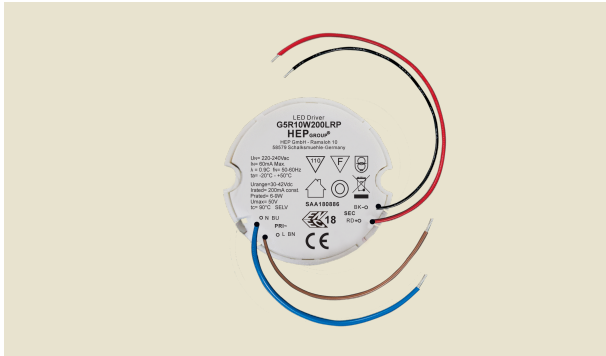

#### Approval Marks



#### Electronic

Parameter	Conditions	Min	Nom	Max	Unit
I/P Voltage Range		198	220-240	264	Vac
Input Frequency		50	50	60	Hz
Input Power	G5R10W200LRP	7	-	11	W
	G5R10W250LRP	8	-	13	W
	G5R10W350LRP	8	-	11	W
	G5R10W500LRP	7.5	-	12	W
	G5R10W700LRP	8	-	11	W
Input Current	G5R10W200LRP @230V	-	-	60	mA
	G5R10W250/350/500/700LRP @230V	-	-	65	mA
Output Voltage Range	G5R10W200/250LRP	30	-	42	Vdc
	G5R10W350LRP	13	-	26	Vdc
	G5R10W500LRP	12	-	20	Vdc
	G5R10W700LRP	8.6	-	12.9	Vdc
Output Current Range	G5R10W200LRP @220V~240V	190	200	210	mA
	G5R10W250LRP @220V~240V	238	250	263	mA
	G5R10W350LRP @220V~240V	333	350	368	mA
	G5R10W500LRP @220V~240V	475	500	525	mA
	G5R10W700LRP @220V~240V	665	700	735	mA
Rated Output power	G5R10W200LRP	6	-	9	W
	G5R10W250LRP	7.5	-	10	W
	G5R10W350LRP	4.5	-	10	W
	G5R10W500LRP	6	-	10	W
	G5R10W700LRP	6	-	10	W
No-Load Voltage	G5R10W200LRP	-	-	50	V
	G5R10W250LRP	-	-	50	V
	G5R10W350LRP	-	-	35	V
	G5R10W500LRP	-	-	28	V
	G5R10W700LRP	-	-	20	V
THD		-	-	15	%
Efficiency	Full Load	83	-	-	%
Standby Power	No load@230V	-	-	0.5	W
Rise Time		-	-	500	ms
Start-up Delay		-	-	500	ms
Ripple current	peak to peak @ full O/P voltage range	-	-	8	%
Output Current Overshoot		-10	-	10	%
Power Factor	Full Load	0.90	-	-	-
Protection	Over-voltage Protection		Auto recovery		
	Open-circuit Protection		Max output voltage at no load		
	Short-circuit Protection		Auto recovery		

**Constant Current LED Driver**

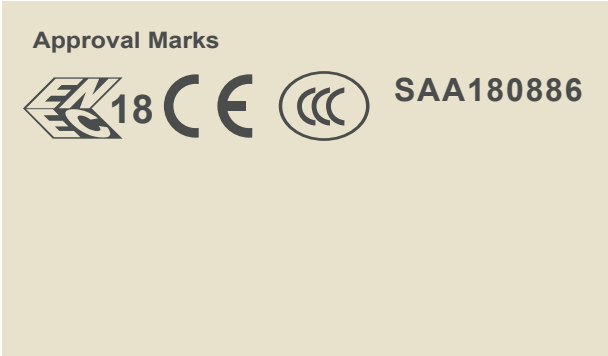
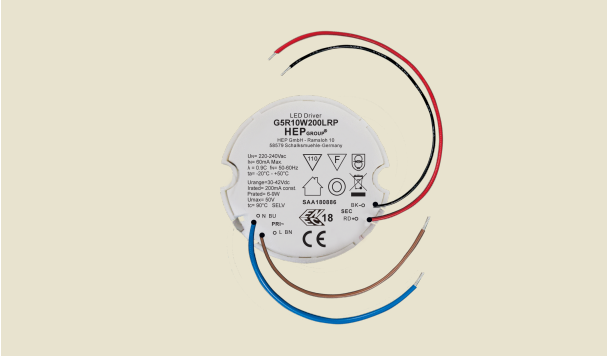

**Electronic**

Parameter	Conditions	Min	Nom	Max	Unit
RoHS Standard			Compliant		
Case Temp. (Tc)		-	-	90	°C
External Operating Temperature		-20	-	+50	°C
Operating humidity range		10	-	95	%
Storage Temp. range		-40	-	+85	°C
Lifetime	Full Load @ Ta = 50°C	-	50,000	-	hrs
Case Dimensions	∅L x H	48	-	22	mm

**Physical**

Parameter

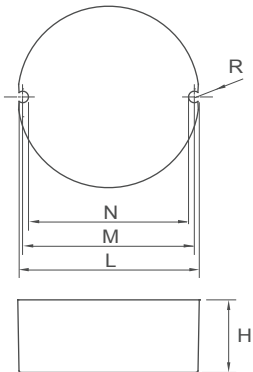

L : 48 mm    M : 46.7 mm    N : 43.5 mm  
 H : 22 mm    R : 1.6 mm

Tolerance :  $\geq 0 \sim 100 \geq \pm 0.5\text{mm}$   
 $100 \geq \pm 1\text{ mm}$

Terminal Block : Hard Wires : PRI : Blue / Brown 140mm AWG#18  
 SEC: Red / Black 140mm AWG#22

Housing Material : Polycarbonate / Potting  
 Soldering : Lead-Free, Comply With RoHS  
 Label : Surface Print

**Wiring Diagram**

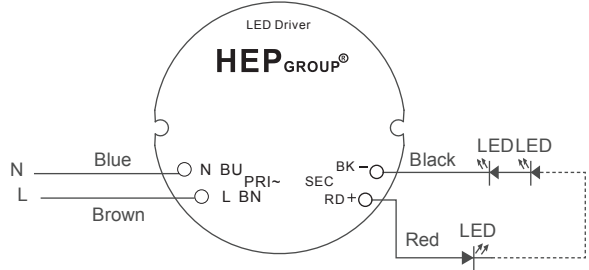

**tc point at bottom side of the case**

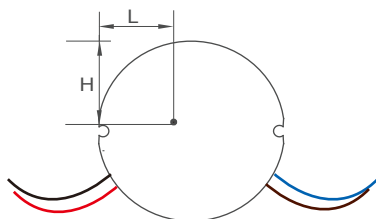

L : 17.5 mm    H : 19.5 mm