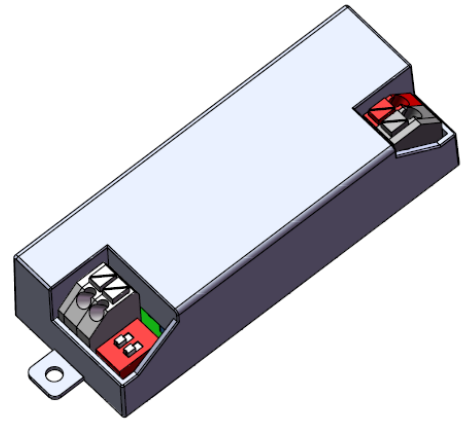

OT FIT 8/220-240/180 CS mini

Constant Current LED Power Supply

90mA - 120mA - 150mA- 180mA

OPTOTRONIC® LED Power Supply
with high reliability in extra small & compact
housing. Equips with 4 selectable currents fits in
light fixtures for shop and office lighting.

**Benefits:**

Extra small housing enable very compact fixture design;
1 driver with 4 output currents;
High quality light with very low ripple;
Long lasting and high reliability
Safety ensured by OSRAM (SELV)
5 years guarantee

Applications

Downlights, Spotlights and other indoor luminaires

Approval marks (under preparation if not on label)

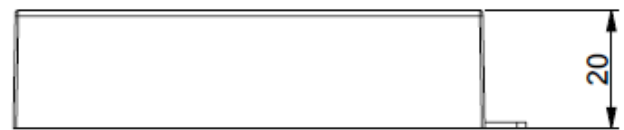
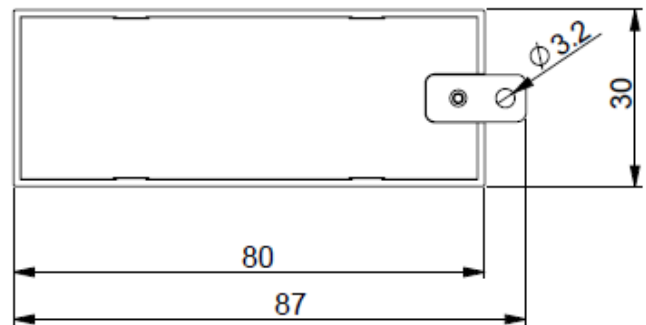

mounting plate removable

Product features

- Output currents: 90/120(TBC)/150/180mA
- Output voltage: 30V_{DC} – 42V_{DC}
- Output power: 2.7W – 7.6W
- Suitable for class I and II luminaires
- Fixed Output (no dimming)
- Low ripple, Low THD
- Extra small housing
- Typ. Efficiency: 85%
- SELV
- 50'000 hours lifetime

Electrical Specifications

	Item	Value	Unit	Remarks
INPUT	Nominal voltage	220 – 240	V _{AC}	
	Nominal frequency	50 / 60	Hz	
	AC voltage	198 – 264	V _{AC}	Safety voltage range
	DC voltage range	NA	V	
	Maximum voltage	275	V	2hrs
	Nominal current	TBC	mA	230V, Refer to Table 1 for details
	Total Harmonic Distortion (THD)	< 15	%	Full load, 230 V, 50 Hz / see graphs
	Power factor	0.95		Full load, 230 V, 50 Hz / see graphs
	Efficiency	85	%	Full load, 230 V, 50 Hz, typical / see graphs
	No-load power	< 0.5	W	230V, typical
	Power loss	TBC	W	at 230V, Input power 24 W max. Refer to Table 1 for details
	Protection class	II		Suitable for class I and class II luminaires
	Inrush current	TBC	A	t _{width} = 100 μs typical (measured at 50% I _{peak})
	Max. units per circuit breaker	B16: TBC; B10: TBC		
Leakage current	< 0.7	mA	Output floating	
OUTPUT	Nominal voltage range	30 – 42	V _{DC}	Refer to Table 1 for details
	Maximum voltage	60	V _{DC}	Open circuit
	Nominal current range	90/120/150/180	mA	
	Current accuracy	+/- 7.5	%	I _{out} = 90mA < +/- 10 %
	Current ripple	< 5	%	Ripple / average @ 100 Hz
	Nominal power range	2.7 – 7.6	W	Partial Load. Refer to Table 1 for details
	Maximum power	7.6	W	Refer to Table 1 for details
	Galvanic isolation	SELV		Output to mains - Touch current < 0.7 mA
DIMMING	Dimming control	No		Not dimmable
	Dimming range	NA	%	
	Dimming technique	NA		
	Frequency	NA	Hz	
	Galvanic isolation	NA		
ENVIRONMENT	Ambient temperature range t _a	-20 ... +55	°C	Refer to Table 1 for details
	Maximum case temperature t _c max	TBC	°C	Measured on t _c point indicated on the product label.
	Max. Case temp. in fault condition	110	°C	
	Storage temperature range	-20 ... +80	°C	Cool down before operating
	Relative humidity	5 ... 85	%	Not condensing
	Surge transient protection	1 2	kV	L/N LN/PE acc. IEC 61547
	Environmental rating	Indoor		
	IP rating	IP 20		
	Mains switching cycles	> 100'000		
Expected lifetime	50'000	hrs	t _c = TBC°C (operating at T _c , max. failure rate of 10 %)	

Protections

Over temperature

Automatic, reversible

Overload

Automatic, reversible

No load

Yes. Limitation of Output voltage < 60V

Short-circuit

Automatic, reversible

Input overvoltage

Maximum allowed input voltage 275V AC

Output overvoltage

Yes. Limitation of Output voltage < 60V

Wiring Diagram

Terminal:	Push in terminals
Max. cable length	2 m
Geometry (l x b x h):	80 x 30 x 20 mm (without mounting plate) 87 x 30 x 20 mm (with mounting plate)
Weight:	TBD

Wire preparation:

Push in

s: 0.5-1.5

f: 0.75-1.5



7-8 mm

For build-in: 0.5-1.5 mm², for independent: 0.75-1.5 mm²

Hot plug-in or secondary switching of LEDs is not permitted and may cause a very high current to the LEDs.

Table 1 - Rated output power and current sets				
I out (mA)	90	120	150	180
U min [V]	30	30	30	30
U max [V]	42	42	42	42
P min [W]	2.7	3.6	4.5	5.4
P max [W]	3.8	5.0	6.3	7.6
Ta [°C]	55	55	55	55
Tc [°C]	TBC	TBC	TBC	TBC
Line Current, nominal@230V mA	TBC	TBC	TBC	TBC
Max Power Loss@230V [W]	TBC	TBC	TBC	TBC
Input Power @230V [W]	TBC	TBC	TBC	TBC

Pin1	Pin2	Current
ON	ON	180
ON	OFF	150
OFF	ON	120
OFF	OFF	90

Current selection by DIP-switch

Standards

Safety: IEC 61347-1, IEC 61347-2-13

Performance: IEC 62384

Harmonic content: IEC 61000-3-2

Immunity: IEC 61000-3-3

IEC 61547

EAN10	Product name	Pieces / box
4052899587922	OT FIT 8/220-240/180 CS S MINI	20pcs

Manufacturer's address:

OSRAM GmbH

Steinerne Furt 62 D-86167 Augsburg
Germany

www.osram.com

Technical support:

Kunden Service Center Germany
+49 (0)89-6213-60 00