

Item	Value	Remark	
Nominal voltage	220–240V		
Nominal frequency	50–60Hz		
AC voltage range	198–264V		
DC voltage range (start)	NA		
DC voltage range (operation)	NA		
Maximum voltage	264Vac	2 h maximum.unit might not operate in this abnormal condition	
Input	Nominal current		
	G5RT15W300LRP	90mA	
	G5RT15W350/500/700LRP	100mA	
	Total Harmonic Distortion (THD)	<20%	Full load @230VAC
	Power factor	0.9C	Full load @230VAC
	Efficiency		
	G5RT15W300/350/500LRP	80%(Typ.)	Full load @230VAC
	G5RT15W700LRP	78%(Typ.)	Full load @230VAC
	No-load power	NA	
	Stand-by power	NA	
	Protection class	NA	
	Inrush current	14A/8.5us	
	Earth leakage current	NA	
Output	Nominal voltage range		
	G5RT15W300LRP	26-43Vdc	
	G5RT15W350LRP	26-43Vdc	
	G5RT15W500LRP	18-30Vdc	
	G5RT15W700LRP	13-21Vdc	
	Maximum voltage		
	G5RT15W300LRP	55Vdc	
	G5RT15W350LRP	55Vdc	
G5RT15W500LRP	38Vdc		
G5RT15W700LRP	28Vdc		

	Item	Value	Remark
Output	Nominal current range		
	G5RT15W300LRP	300mA	
	G5RT15W350LRP	350mA	
	G5RT15W500LRP	500mA	
	G5RT15W700LRP	700mA	
	Current accuracy	± 5%	
	Typical output LF current ripple	± 5%	Low Frequency<120Hz
	Nominal power range		
	G5RT15W300LRP	7.8-12.9W	
	G5RT15W350LRP	9.1-15W	
G5RT15W500LRP	9-15W		
G5RT15W700LRP	9.1-14.7W		
Maximum power	15.05W		
Dimming	Dimming control	Trailing Edge	
	Dimming technique	Amplitude	
	PWM frequency	NA	
	Dimming range	10-100%	
	Lowest dimming current	2-6%	
	Galvanic isolation	NA	
Environment	Ambient temperature range t_a	-20°C...+50°C	
	Maximum case temperature t_c	85 °C	bottom
	Max. case temp. in fault condition	110°C	When operating under fault conditions, the temperature of the enclosure at any location should not exceed 110 °C
	Storage temperature range	-40°C...+85°C	
	Relative humidity	10%...95%	
	Surge transient protection	1 kV	L/N
	Environmental rating	Indoor	
	IP rating	IP20	
	Mains switching cycles	> 100,000	
	Expected lifetime	> 50,000 h, t_c 85 °C @ t_a 50 °C > 100000 h, t_c 75 °C @ t_a 40 °C	0.2 % / 1,000 h failure rate 0.1 % / 1,000 h failure rate
Packing	Gross weight/box	14.2 Kg	
	Net weight/box	13.2 Kg	
	Pcs/box	180 PCS	
	Dimension/box	385(L)*310(W)*260(H)mm	
Protections			
Short- & open circuit proof, Auto. overheat regulation or cut off, Overload protection			
Conformity & Standards			
Safety standard:	EN 61347-1, EN 61347-2-13, EN 62493		
Performance:	EN 62384		
EMC standard:	EN 55015, EN 61000-3-2, EN 61000-3-3, EN 61547		

Cable information

PRI Connection	L	N
Color	Brown	Blue
Wire type	7022	7022
Wire diameter	AWG20	AWG20
Wire length	140mm	140mm
Stripping	6mm	6mm
Sec Connection	+	-
Color	Red	Black
Wire type	1332	1332
Wire diameter	AWG22	AWG22
Wire length	139mm	139mm
Stripping	6mm	6mm

Subject to change without notice, HEP guarantees all products perform functionally well

Trailing Edge Dimmer list approved by HEP

Manufacturer	Model	Qty of parallelconnection
HEP	DCT101	12
HEP	DCT202	5
Philips	SED-200A	11
Merten/Schneider	SBD315RC	15
Etman	ETM327	15
Etman	ETM329	15

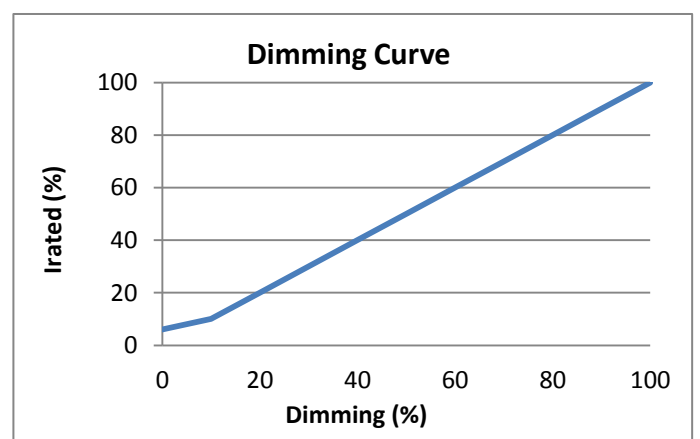
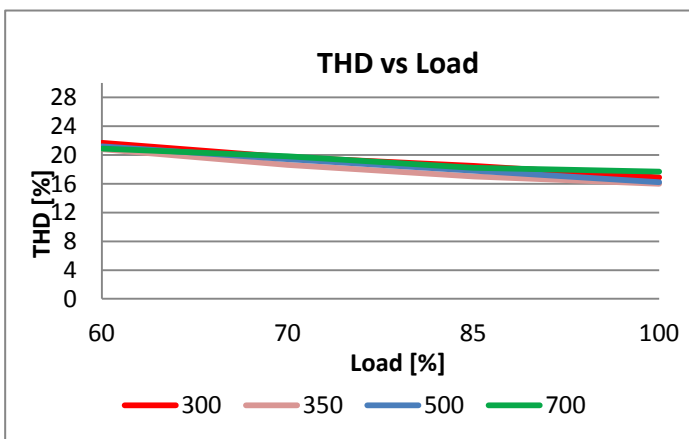
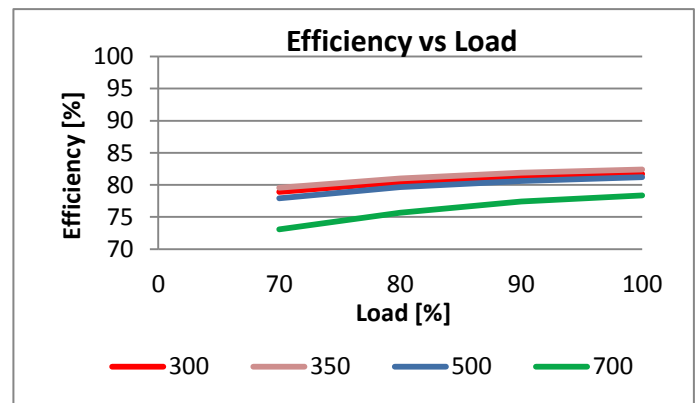
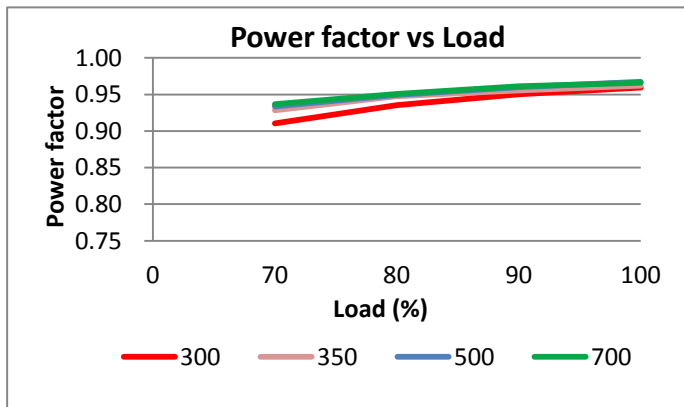

**Physical
Parameter**

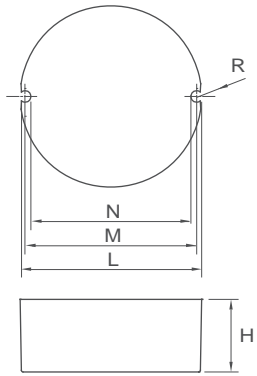

L : 48 mm M : 46.7 mm N : 43.5 mm
 H : 25 mm R : 1.6 mm

Tolerance : +/-1 mm , R : +/-0.5 mm

Housing Material : Polycarbonate / Potting
 Soldering : Lead-Free, Comply With RoHS
 Label : Surface Print

Wiring Diagram

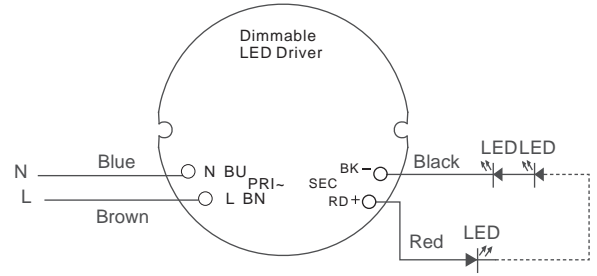

TC location (Bottom)

