

Item	Value	Remark
Nominal voltage	220–240V	
Nominal frequency	50–60Hz	
AC voltage range	198–264V	
DC voltage range (start)	NA	
DC voltage range (operation)	NA	
Maximum voltage	264Vac	2 h maximum.unit might not operate in this abnormal condition
Nominal current	70mA	
Total Harmonic Distortion (THD)	< 20%	Full load @230VAC
Power factor	0.9C	Full load @230VAC
Displacement factor	0.9C	Full load @230VAC
Efficiency		
G5RT10W200/250/350/500LRP	80%(Typ.)	Full load @230VAC
G5RT10W700LRP	74%(Typ.)	Full load @230VAC
No-load power	NA	
Stand-by power	NA	
Protection class	NA	
Inrush current	12.4A / 7.2us	
Earth leakage current	NA	
Nominal voltage range		
G5RT10W200/250LRP	30-42Vdc	
G5RT10W350LRP	13-26Vdc	
G5RT10W500LRP	12-20Vdc	
G5RT10W700LRP	8.6-12.9Vdc	
Maximum voltage		
G5RT10W200/250LRP	55Vdc	
G5RT10W350LRP	35Vdc	
G5RT10W500LRP	28Vdc	
G5RT10W700LRP	25Vdc	
Nominal current range		
G5RT10W200LRP	200mA	
G5RT10W250LRP	250mA	

	Item	Value	Remark
Output	G5RT10W350LRP	350mA	
	G5RT10W500LRP	500mA	
	G5RT10W700LRP	700mA	
	Current accuracy	± 5%	
	Typical output LF current ripple	± 5%	Low Frequency<120Hz
	Starting time	< 0.5 S	Full load @230VAC
	Nominal power range		
	G5RT10W200LRP	6-8.4W	
	G5RT10W250LRP	7.5-10.5W	
	G5RT10W350LRP	4.6-9.1W	
G5RT10W500LRP	6-10W		
G5RT10W700LRP	6-9W		
Maximum power	10.5W		
Dimming	Dimming control	Trailing Edge	
	Dimming technique	Amplitude	
	PWM frequency	NA	
	Dimming range	10-100%	
	Lowest dimming current	2-6%	
	Galvanic isolation	NA	
Environment	Ambient temperature range t_a	-20°C...+50°C	
	Maximum case temperature t_c	85°C	bottom
	Max. case temp. in fault condition	110°C	When operating under fault conditions, the temperature of the enclosure at any location should not exceed 110 °C.
	Storage temperature range	-40°C...+85°C	
	Relative humidity	10%...95%	
	Surge transient protection	1 kV	L/N
	Environmental rating	Indoor	
	IP rating	IP20	
	Mains switching cycles	> 100,000	
	Expected lifetime	> 50,000 h, t_c 85 °C @ t_a 50 °C > 100000 h, t_c 75 °C @ t_a 40 °C	0.2 % / 1,000 h failure rate 0.1 % / 1,000 h failure rate
Packing	Gross weight/box	14.6 Kg	
	Net weight/box	13.5 Kg	
	Pcs/box	180 PCS	
	Dimension/box	385(L)*310(W)*260(H)mm	
Protections			
Short- & open circuit proof, Auto. overheat regulation or cut off, Overload protection			
Conformity & Standards			
Safety standard:	EN 61347-1, EN 61347-2-13, EN 62493		
Performance:	EN 62384		
EMC standard:	EN 55015, EN 61000-3-2, EN 61000-3-3, EN 61547		

Cable information

PRI Connection	L	N
Color	Brown	Blue
Wire type	7022	7022
Wire diameter	AWG20	AWG20
Wire length	140mm	140mm
Stripping	6mm	6mm
SEC Connection	+	-
Color	Red	Black
Wire type	1332	1332
Wire diameter	AWG22	AWG22
Wire length	139mm	139mm
Stripping	6mm	6mm

Subject to change without notice, HEP guarantees all products perform functionally well

Trailing Edge Dimmer list approved by HEP

Manufacturer	Model	Q'ty of parallelconnection
HEP	DCT101	15
HEP	DCT202	7
Philips	SED-200A	13
Merten/Schneider	SBD315RC	20
Etman	ETM327	20
Etman	ETM329	20

Electrical Values

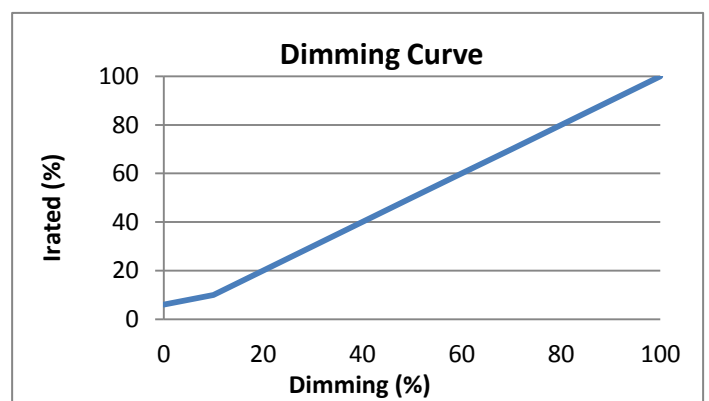
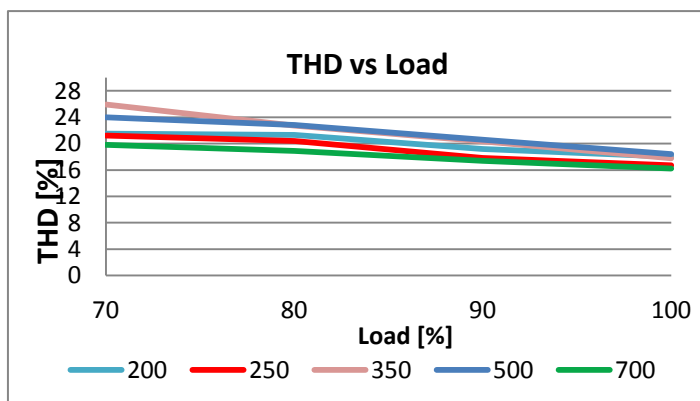
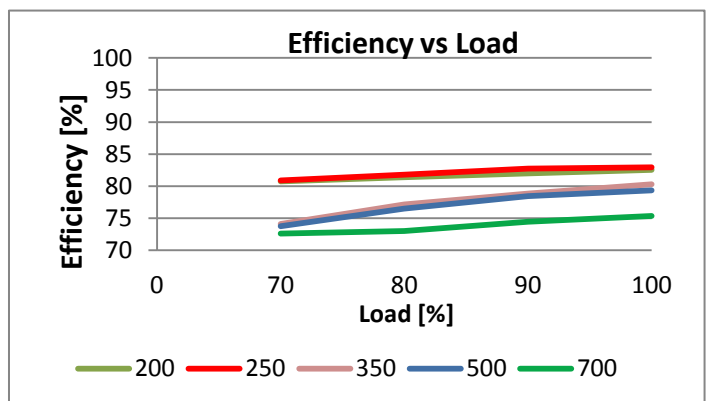
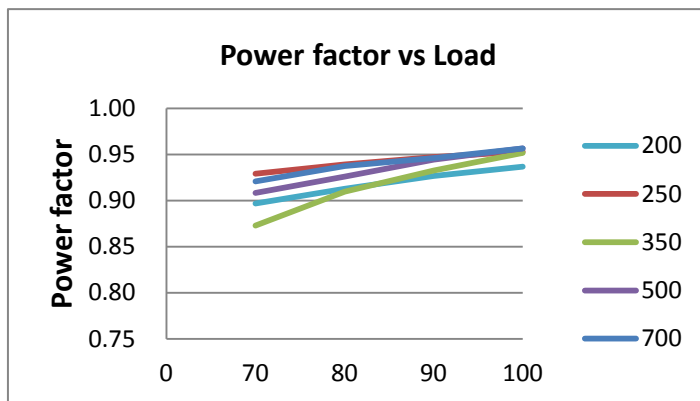

**Physical
Parameter**

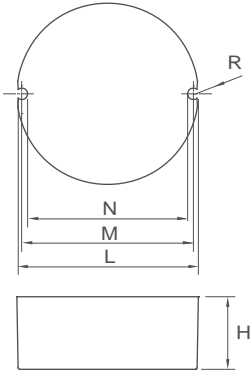

L : 48 mm M: 46.7 mm N : 43.5 mm

H : 25 mm R : 1.6 mm

Tolerance : +/-1 mm , R : +/-0.5 mm

Housing Material : Polycarbonate / Potting
 Soldering : Lead-Free, Comply With RoHS
 Label : Surface Print

Wiring Diagram

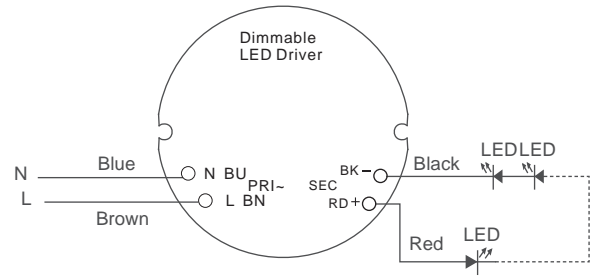

TC location (Bottom)

