

Approval Marks



Item	Value	Remark
Nominal voltage	220–240V	
Nominal frequency	0 / 50–60Hz	
AC voltage range	198–264V	
DC voltage range (start)	NA	
DC voltage range (operation)	NA	
Maximum voltage	264VAC	
Nominal current	130mA	
Total Harmonic Distortion (THD)	< 15%	Full load @230VAC
Power factor	0.9C	Full load @230VAC
Displacement factor	0.9C	Full load @230VAC
Efficiency	86%	Full load @230VAC
No-load power	NA	
Stand-by power	NA	
Protection class	II	Suitable for class II luminaires
Inrush current	8.3A / 140us	Nominal
Max.units per circuit breaker	Type B , 10A MCB	31
	Type B , 16A MCB	49
	Type C , 10A MCB	38
	Type C , 16A MCB	62
Earth leakage current	NA	
Nominal voltage range	30-42 Vdc	
Maximum voltage	53Vdc	
Nominal current range		
I _{out} =250mA	250mA	Full load @230VAC
I _{out} =350mA	350mA	Full load @230VAC
I _{out} =410mA	410mA	Full load @230VAC
I _{out} =500mA	500mA	Full load @230VAC
Current accuracy	± 5%	
Typical output LF current ripple	± 4%	Low Frequency< 120Hz Full load @230VAC
SVM	≤ 0.4	Full load @230VAC
P _{stLM}	≤ 1	Full load @230VAC
Starting time	< 0.5 S	Full load @230VAC

	Item	Value	Remark
Output	Nominal power range		
	I _{out} =250mA	7.5-10.5W	
	I _{out} =350mA	10.5-14.5W	
	I _{out} =410mA	12-17W	
	I _{out} =500mA	15-21W	
	Maximum power	21W	
Dimming	Dimming control	NA	
	Dimming technique	NA	
	PWM frequency	NA	
	Dimming range	NA	
	Lowest dimming current	NA	
	Galvanic isolation	NA	
Environment	Ambient temperature range t _a	-20°C - +50°C	
	Maximum case temperature t _c	90°C	Bottom
	Max. case temp. in fault condition	110°C	When operating under fault conditions, the temperature of the enclosure at any location should not exceed 110 °C
	Storage temperature range	-25°C - +85°C	
	Relative humidity	10% - 95%	
	Surge transient protection	1 kV	L/N
	Environmental rating	Indoor	
	IP rating	IP20	
	Mains switching cycles	> 100,000	
	Expected lifetime	> 50,000 h, t _c 90 °C @ t _a 50 °C > 100000 h, t _c 80 °C @ t _a 40 °C	0.2 % / 1,000 h failure rate
Packing	Gross weight/box	7.5 kg	
	Net weight/box	6.1 kg	
	Pcs/box	100 PCS	
	Dimension/box	490(L)*270(W)*225(H)mm	
Protections			
	Short- circuit protection	Auto recovery	
	Open- circuit protection	Auto recovery	
	Overload protection	Auto recovery	
Conformity & Standards			
	Safety standard:	EN 61347-1, EN 61347-2-13, EN 62493	
	Performance:	EN 62384	
	CCC standard:	GB17625.1,GB/T17743,GB19510.1,GB19510.14	
	EMC standard:	EN 55015, EN 61000-3-2, EN 61000-3-3, EN 61547	
Cable information			
PRI			
	Cable cross-section	0.75-1.5□/AWG 18-16	
	Stripping	6mm	
	Pull test cable type	H03VV(H2)-F 2x0,75-1,5 mm ² ,H05VV(H2)-F 2x0,75-1,5 mm ²	
SEC			
	Cable cross-section	0.5-1.5□/AWG 20-16	
	Stripping	6mm	
Terminal information			
PRI-Screw type			
SEC-Screw type			



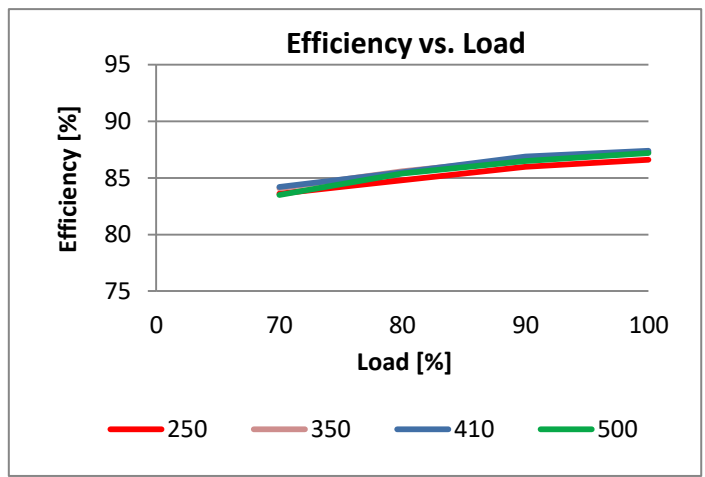
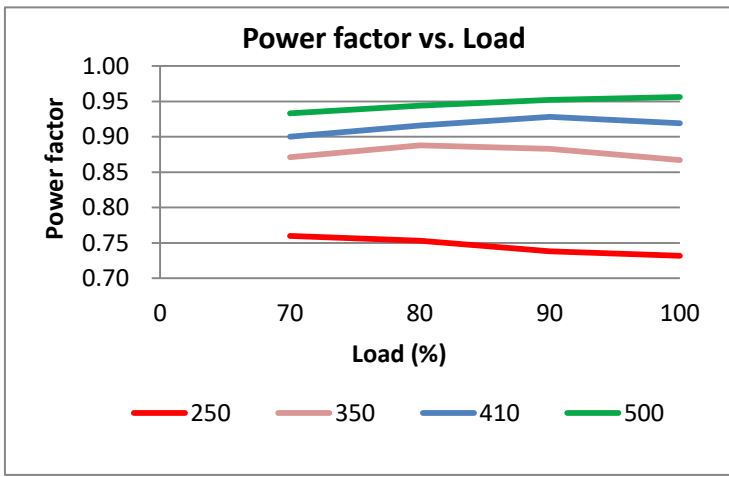
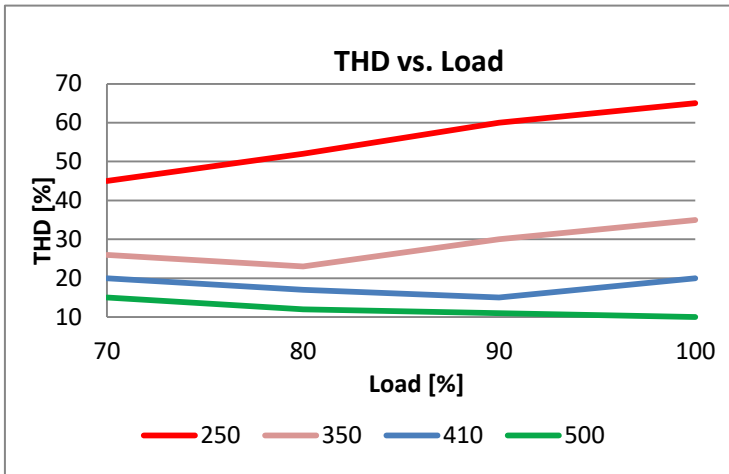

* If not mentioned, all the test conditions are based on full load at 230VAC input (for 220-240 VAC input).

Subject to change without notice, HEP guarantees all products perform functionally well

Electrical Values



Dip Switch - One driver offers 4 choosable output current

Order Code	   
G5S20W500CA-Z	250mA / 350mA / 410mA / 500mA

Physical

Parameter

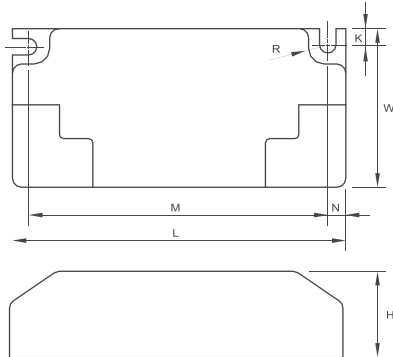

- L : 85 mm
- M : 76.4 mm
- N : 4.6 mm
- W : 40.4 mm
- H : 22 mm
- K : 4.0 mm
- R : 2.1mm
- Slot On One Side Allowing Alignment : M \pm 3 mm
- Tolerance : $\geq 0 \sim 100 > \pm 0.5$ mm
 $100 \geq \pm 1$ mm
- Terminal Block : PRI : Screw Type
SEC : Screw Type
- Housing Material : Polycarbonate
- Soldering : Lead-Free, Comply With RoHS
- Label : Surface Print

Wiring Diagram

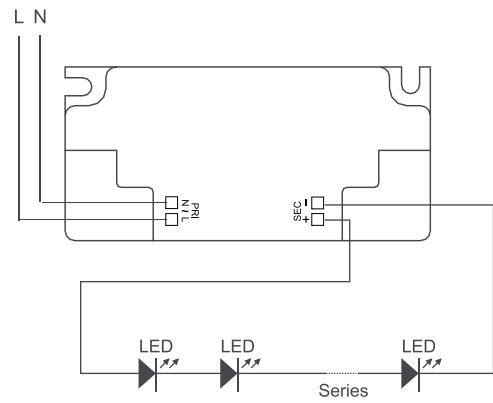

The length of wire from output to luminaire should be less than 2M